



# PIGSTY SIDE WALLS

## GRID SUPPORTING WALL

To make the discharge collection tanks Fattori srl has introduced a new element that completes the existing range of products.

The new prefabricated pigsty side wall is represented by elements with a maximum length five metres that, once positioned on the perfectly flat support bands create the buffer wall for the external pigsty wall with lower plinth to support the grid.

The assembly operations are completed with the sealing of the joints and the laying of the internal flooring that functions as anchorage for the elements themselves.



**FATTORI**  
SISTEMI E STRUTTURE IN CEMENTO ARMATO

Via F. Cavallotti, 298 - 25018 Montichiari (Bs) - Tel. 030.963291 - Fax 030.9964333  
[www.gffattori.it](http://www.gffattori.it) - [info@gffattori.it](mailto:info@gffattori.it)



# TECHNICAL PRODUCT DATA SHEET

## PLAN

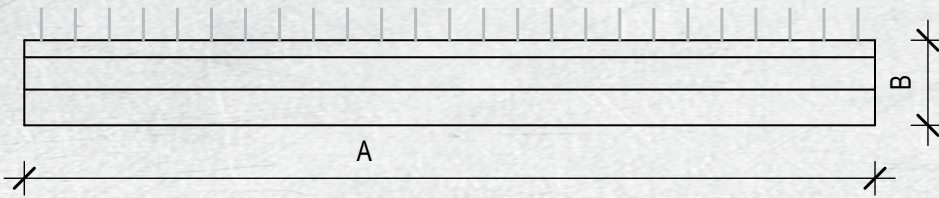

## SECTION

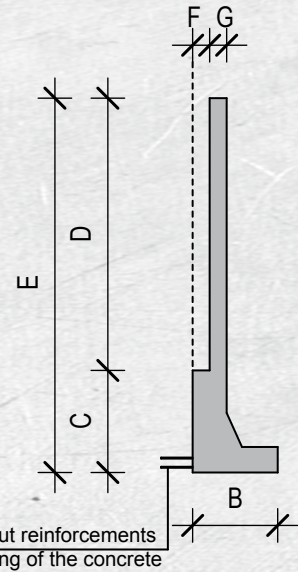

## SECTION: TYPE

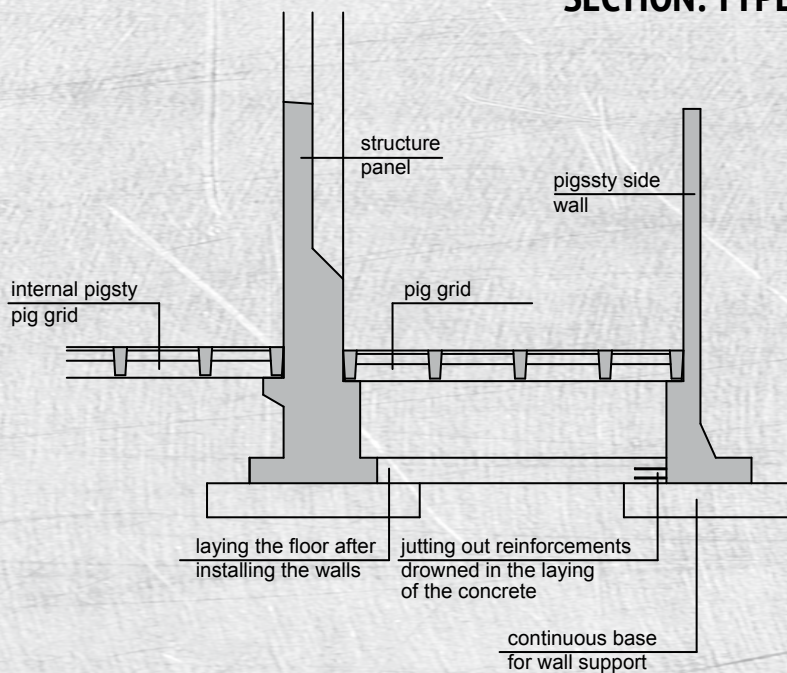

### TECHNICAL CHARACTERISTICS

#### CONCRETE:

R'ck scassero  $\geq 20$  N/mm<sup>2</sup>  
R'ck a 28 gg  $\geq 40$  N/mm<sup>2</sup>

#### STEEL B450C Checked:

f<sub>yk</sub>  $\geq 450$  N/mm<sup>2</sup>  
f<sub>tk</sub>  $\geq 540$  N/mm<sup>2</sup>

#### WELDMESH:

STEEL B450A

#### EXPOSURE CLASS XC3

bar cover 2,5 cm  
bar free interspace  $\geq 2$  cm  $\geq \emptyset$  max  
R.E.I. 30

### TOLERANCES

length  $\pm 1,0$  cm  
height  $\pm 0,5$  cm  
width  $\pm 1,0$  cm  
mild reinforcement  $\pm 1,0$  cm

ARTICLE CODE	A	B	C	D	E	F	G	Weight kg/cad
MURPAL500195	500	50	60	135	195	10	10	3700
MURPAL500220	500	50	85	135	220	10	10	4300

The table shows the standard sizes; we can also produce non-standard sizes upon prior arrangements with our offices

The sizes shown are indicative, **FATTORI** reserves the right to make any changes at any time without prior notice.