

TRANSVERSE CATTLE GRID H.16



STALL FLOORING

For cattle farming Fattori srl manufactures grids according to the requirements of the European standard EN 12737:2007 which imposes precise characteristics:

- Rck 40 concrete
- guaranteed durability in XC3 classified environment
- high quality B450C steel calculated to ensure the required performance
- slots with a width of 3.00 cm and rounded to limit the possibility of injury to the feet
- production lots that allow the traceability of the raw materials used and provide further guarantees for the purchaser

The production process is monitored at every stage, starting from the incoming raw materials, and in every single process until the loading of the finished product.

It is a cutting edge product at a European level.



FATTORI
SISTEMI E STRUTTURE IN CEMENTO ARMATO

Via F. Cavallotti, 298 - 25018 Montichiari (Bs) - Tel. 030.963291 - Fax 030.9964333
www.gffattori.it - info@gffattori.it

TECHNICAL SPECIFICATIONS

PLAN

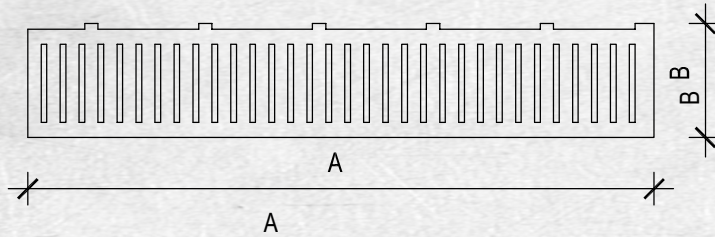

LONGITUDINAL SECTION PLAN VIEW

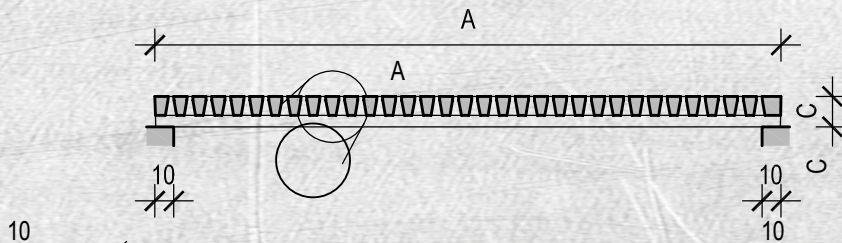

10

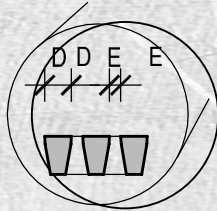

TRANSVERSE SECTION VIEW

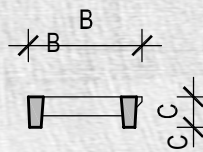

TECHNICAL CHARACTERISTICS OF THE ELEMENT

VARIABLE LIVE LOAD:

1500-1800 Kg/mq in addition to its own weight

CONCRETE:

R_{ck} formwork ≥ 20 N/mm²

R_{ck} a 28 day ≥ 40 N/mm²

STEEL B450C checked:

f_{yk} ≥ 450 N/mm²

f_{tk} ≥ 540 N/mm²

WELDMESH:

Steel B450A

EXPOSURE CLASS XC3

bar cover 2,5cm

bar free interspace ≥ 2 cm $\geq \emptyset$ max

REI 30

TOLLERANCES

length $\pm 1,0$ cm

height $\pm 0,5$ cm

width $\pm 1,0$ cm

mild reinforcement $\pm 1,0$ cm



1982-CPR-331
EN 12737

ITEM CODE	A	B	C	D	E	Flow Kg/mq	Weight Kg/cad	Empty mq	Full mq	Ratio Empty/full
GVT1006016	100	60	16	7,00	3,00	1000	117	0,135	0,464	29%
GVT1106016	110	60	16	7,00	3,00	1000	129	0,150	0,509	30%
GVT1206016	120	60	16	7,00	3,00	1000	140	0,166	0,552	30%
GVT1306016	130	60	16	7,00	3,00	1000	152	0,179	0,600	30%
GVT1406016	140	60	16	7,00	3,00	1000	164	0,194	0,645	30%
GVT1506016	150	60	16	7,00	3,00	1000	176	0,210	0,690	30%
GVT1606016	160	60	16	7,00	3,00	1000	188	0,225	0,734	31%
GVT1706016	170	60	16	7,00	3,00	1000	199	0,240	0,779	31%
GVT1806016	180	60	16	7,00	3,00	1000	211	0,255	0,824	31%
GVT1906016	190	60	16	7,00	3,00	1000	222	0,269	0,870	31%
GVT2006016	200	60	16	7,00	3,00	1000	234	0,284	0,915	31%
GVT2106016	210	60	16	7,00	3,00	1000	246	0,299	0,960	31%

ITEM CODE	A	B	C	D	E	Flow Kg/mq	Weight Kg/cad	Empty mq	Full mq	Ratio Empty/full
GVT2206016	220	60	16	7,00	3,00	1000	258	0,315	1,005	31%
GVT2306016	230	60	16	7,00	3,00	1000	270	0,330	1,049	31%
GVT2406016	240	60	16	7,00	3,00	1000	281	0,345	1,094	31%
GVT2506016	250	60	16	7,00	3,00	1000	293	0,358	1,141	31%
GVT2606016	260	60	16	7,00	3,00	1000	305	0,374	1,185	31%
GVT2706016	270	60	16	7,00	3,00	1000	316	0,389	1,230	31%
GVT2806016	280	60	16	7,00	3,00	1000	328	0,404	1,275	31%
GVT2906016	290	60	16	7,00	3,00	1000	340	0,420	1,320	31%
GVT3006016	300	60	16	7,00	3,00	1000	352	0,433	1,366	31%
GVT3106016	310	60	16	7,00	3,00	1000	364	0,436	1,424	31%
GVT3206016	320	60	16	7,00	3,00	1000	376	0,463	1,456	31%
GVT3306016	330	60	16	7,00	3,00	1000	388	0,479	1,500	31%

The table shows the standard sizes; we can also produce non-standard sizes upon prior arrangements with our offices.

The sizes shown are indicative, **FATTORI** reserves the right to make any changes at any time without prior notice.