

# FLAT/CLOSED FEEDER



## FEEDING LANE

Upon completion of the cattle farming installations Fattori srl manufactures prefabricated elements for the creation of the feeding lanes: these are modules available both in the flat model and the closed model, at the discretion of the client.

These modules, placed side by side, create continuous lines on which it is possible to anchor the feeding stalls either using iron plates with brackets embedded inside the product. The spacing between the plates is 300 cm in the standard model but it can be changed according to the needs of the customer.

If there are pillars it is also possible to create cut aways in the products.

Acid-resistant epoxy resin for use with food is available on request to prevent surface corrosion due to contact with aggressive agents.



**FATTORI**  
SISTEMI E STRUTTURE IN CEMENTO ARMATO

Via F. Cavallotti, 298 - 25018 Montichiari (Bs-Italy) - Tel. +39 030.963291 - Fax +39 030.9964333  
[www.gffattori.com](http://www.gffattori.com) - [info@gffattori.it](mailto:info@gffattori.it)

# TECHNICAL SPECIFICATIONS

## FLAT FEEDER

### PLAN

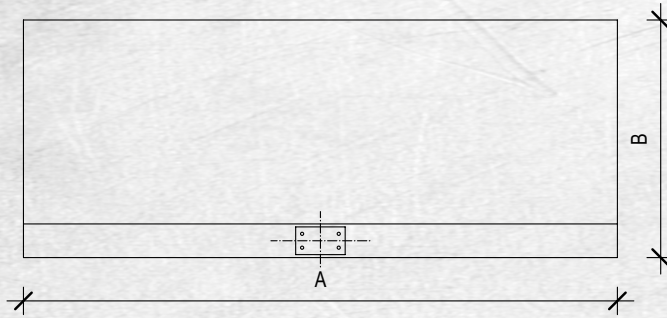

### SECTION

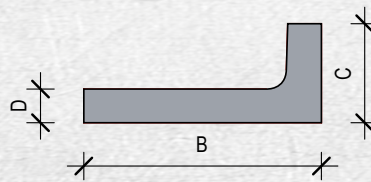

## CLOSED FEEDER

### PLAN

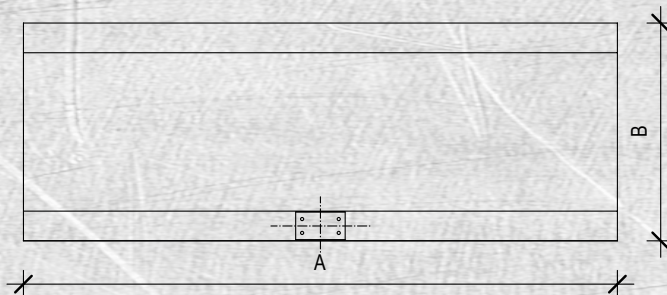

### SECTION

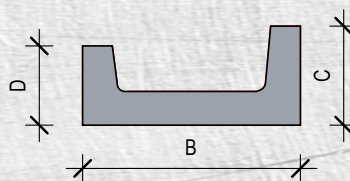

#### TECHNICAL CHARACTERISTICS OF THE ELEMENT

##### CONCRETE:

R<sub>ck</sub> formwork  $\geq 20$  N/mm<sup>2</sup>

R<sub>ck</sub> in 28 day  $\geq 40$  N/mm<sup>2</sup>

##### STEEL B450C checked:

f<sub>yk</sub>  $\geq 450$  N/mm<sup>2</sup>

f<sub>tk</sub>  $\geq 540$  N/mm<sup>2</sup>

##### WELDMESH:

Steel B450A

**EXPOSURE CLASS** XC3

bar cover 2,5cm

bar free interspace  $\geq 2$  cm  $\geq \varnothing$  max

REI 30

##### FASTENERS:

Galvanized iron plate complete with bushings with M 16 threading embedded in the casting with spacing of 70x185 mm for fixing stable cross bars and/or a roof structure.

##### TOLLERANCES

length  $\pm 1,0$  cm

height  $\pm 0,5$  cm

width  $\pm 1,0$  cm

mild reinforcement  $\pm 1,0$  cm

ITEM CODE	A cm	B cm	C cm	D cm	Weight Kg/mL
MANG600P	Max 600	120	50	17	635/mL
MANG300C	Max 300	110	50	40	635/mL

The table shows the standard sizes; we can also produce non-standard sizes upon prior arrangements with our offices.

The sizes shown are indicative, **FATTORI** reserves the right to make any changes at any time without prior notice.